



March 14, 2007

TO: Members, Formation Commission

SUBJECT: LAFCo File No. 07-04-Proposed Annexation of a Portion of Guadalupe Canyon Parkway to the City of Daly City involving Minor Sphere of Influence Amendment

Summary

This proposal submitted by Resolution of the Board of Supervisors requests annexation of approximately 700 feet of Guadalupe Canyon Parkway (1.66 acres) to the City of Daly City. Annexation would facilitate City of Daly City enforcement of traffic safety associated the road and U-turn pocket serving John F. Kennedy Middle School to provide for safe access for student drop off and pick up. The roadway abuts County unincorporated lands that are not in need of city services. Annexation would require amendment of the City's sphere of influence to include the roadway. Commission approval is recommended.

Departmental Reports

County Assessor: As publicly owned land, the subject area is not assessed.

County Clerk: The territory has no registered voters. Annexation would not conflict with any political subdivision boundaries.

Public Works Mapping: The territory proposed for annexation consists of 1.66 acres or 720 feet of improved roadway. The map and legal description submitted with the proposal satisfy the requirements of the State Board of Equalization. The proposal would not necessitate removal from any special districts. Natural boundaries, drainage basins or other topographical features would not affect and would not be affected by this proposal.

Environmental Health: The proposal has no adverse environmental health significance. Approval is recommended.

Planning: San Mateo County General Plan designation for lands that abut roadway is Resource Management.

Report and Recommendation:

The County of San Mateo requests, by resolution of the Board of Supervisors, annexation of 700 feet of roadway (1.22 acres) to the City of Daly City. As stated above, the annexation area includes a section of Guadalupe Canyon Parkway where a U-turn pocket was constructed to allow safe turning movements for drop off and pick up at John F. Kennedy Middle School. Annexation is requested as a component of an agreement between the County and City of Daly City in which the County cooperated on roadway improvements and the City

agreed to annex the roadway.

The proposal is categorically exempt from the environmental review requirements of the California Environmental Quality Act because it involves annexation of existing facilities and lots for exempt facilities (Section 15319 of State CEQA Guidelines).

As publicly owned land, the territory is not assessed and does not generate property tax revenue and the City and the County have therefore adopted resolutions of zero property tax exchange as required by Revenue and Tax Code 99.

The proposed annexation is uninhabited and has consent of the County. The Commission may therefore waive protest proceedings pursuant to Section 56663[c] of the Cortese Knox Hertzberg Act.

Recommendation:

This annexation will place all portions of roadway affected by the U-turn improvements in the City of Daly City's jurisdiction for public safety enforcement. Staff therefore respectfully recommends that the Commission certify that the proposal is exempt from the environmental review requirements of the California Environmental Quality Act under CEQA Guideline Section 15319 and approve the proposed annexation by taking the actions listed below.

Recommended Commission Action, by Resolution:

By resolution, approve LAFCo File No. 07-04--Proposed Annexation of a Portion of Guadalupe Canyon Parkway to the City of City of Daly City, minor sphere of influence amendment and waiver of protest hearings pursuant to Section 56663 [c].

Respectfully submitted,



Martha Poyatos
Executive Officer

C: Brian Lee, Deputy Director, SMC Public Works
David J. Clarke, Deputy Director, SMC Public Works
Peter Gleichenhaus, Director, City of Daly City Public Works

**LOCAL AGENCY FORMATION COMMISSION**

455 COUNTY CENTER, 2ND FLOOR • REDWOOD CITY, CA 94063-1663 • PHONE (650) 363-4224 • FAX (650) 363-4849

January 23, 2007

TO: San Mateo County
City of Daly City
County Office of Education

SUBJECT: LAFCo File No. 07-04 - Proposed Annexation of a
Portion of Guadalupe Canyon Parkway to the City of
Daly City including Minor Sphere of Influence
Amendment (1.66 acres)

Notice is hereby given that an application for the proposed change of organization listed above has been received by the San Mateo Local Agency Formation Commission. The application involves 1.66 acres/approximately 721 feet of Guadalupe Canyon Parkway beginning at the current City of Daly City boundary. The proposal consists of the following proposed organizational changes:

City or DistrictChange of Organization

City of Daly City

Annexation

The proposal application, map and legal description are attached for your information. Please submit comments to the LAFCo office by **February 1, 2007** to assure your input to preparation of the Executive Officer's Report. If you have any questions about this proposal, please contact this office.

A handwritten signature in cursive script that reads "Martha Poyatos".

Martha Poyatos
Executive Officer

APPLICATION FOR A CHANGE OF ORGANIZATION OR REORGANIZATION TO
THE SAN MATEO
LOCAL AGENCY FORMATION COMMISSION

A. GENERAL INFORMATION

1. Briefly describe the nature of the proposed change of organization or reorganization.

Annexation of a portion of Guadalupe Canyon Parkway to the City of Daly City including minor sphere of influence amendment

2. An application for a change of organization or reorganization may be submitted by individuals in the form of a petition or by an affected public agency in the form of a certified resolution. This application is submitted by (check one):

Landowners or registered voters, by petition
 An affected public agency, by resolution (County of San Mateo)

(If this application is submitted by petition of landowners or registered voters in the affected territory, complete the petition form.)

3. What are the reasons for the proposal?

To place into one jurisdiction, all of Guadalupe Canyon Parkway in the area where a U-turn pocket was constructed to allow safe turning movements on Guadalupe Canyon Parkway for the parents/relatives/caregivers that drop off or pick up children at the John F. Kennedy School that is located in the City of Daly City

4. Does this application have 100% consent of landowners in the affected area?

Yes No

5. Estimated acreage: 1.66 acres more or less

B. SERVICES

1. List the name or names of all existing cities and special districts whose service area or service responsibility would be altered by the proposed change of organization or reorganization.

City of Daly City

2. List all changes to the pattern of delivery of local services to the affected area.

Currently, the Guadalupe Canyon Parkway in the immediate area is in the jurisdiction of the County of San Mateo and the City of Daly City. Annexation will place all of the roadway in the jurisdiction of the City of Daly City for emergency response, traffic enforcement, road maintenance, landscaping related to traffic turn around for John F. Kennedy Middle School

C. PROJECT PROPOSAL INFORMATION

1. Please describe the general location of the territory which is the subject of this proposal. Refer to major highways, roads and topographical features: (address, unincorporated San Mateo County

Guadalupe Canyon Parkway from the current corporate limits of the City of Daly City to a point approximately 721 feet more or less northeasterly of the corporate limits of Daly City.

2. Describe the present land use(s) in the subject territory:

Park and open space

3. How are adjacent lands used?

North: Road
South: Road
East: Park and Open Space
West: Park and Open space

4. Will the proposed change of organization result in additional development? If so, how is the subject territory to be developed?

NO

5. What is the County general plan designation of the subject territory?

N/A

6. What is the existing County of San Mateo zoning designation of the subject territory? N/A

7. What rezoning, environmental review or development approvals have already been obtained for development in the subject territory?

N/A, subject territory consists of roadway only

8. What additional approvals will be required to proceed?

None

9. Does any portion of the subject territory contain any of the following --agricultural preserves, sewer or other service moratorium or wetlands subject to the State Lands Commission jurisdiction?

NO

10. If no specific development projects are associated with this proposal, will the proposal increase the potential for development of the property? If so, how?

NO

LAFCo will consider the person signing this application as the proponent of the proposed action(s). Notice and other communications regarding this application (including fee payment) will be directed to the proponent at:

NAME: Brian C. Lee, Acting Director of Public Works

ADDRESS: 555 County Center, 5th Floor,
Redwood City, CA 94063

PHONE: (650) 363-4100

ATTN: _____

Brian C. Lee
Signature of Proponent

Note: Pursuant to Government Code Sections 56700.1 and 81000 et seq. Any person or combination of persons who directly or indirectly contribute \$1000 or more or expend \$1000 or more in support of or opposition to a change of organization or reorganization that has been submitted to the Commission and will require an election must comply with the reporting and disclosure requirements of the Political Reform Act of 1974.

D. AFFECTED PUBLIC AGENCIES (to be completed by City of County)

Please complete this section if this application is submitted by resolution of one or more affected public agencies. Certified copies of resolutions listed below must accompany this application.

1. The names and resolutions of agencies applying for the change of organization or reorganization described above are as follows:

<u>Affected Agency</u>	<u>Resolution No.</u>	<u>Date Adopted</u>
<u>County of San Mateo</u>	<u>No. 068472</u>	<u>January 9, 2007</u>

2. Does this application have 100% consent of landowners in the affected area?
 Yes No (If yes, include proof of consent.)

PLAN FOR PROVIDING SERVICES

1. Enumerate and describe the services to be extended to the affected territory.

City of Daly City will provide city services related to road maintenance, police, emergency response, traffic safety

2. Describe the level and range of those services.

Consistent with services provided by the City in adjacent areas.

3. Indicate when those services can feasibly be extended to the affected territory.

Immediately upon annexation.

4. Indicate any improvements or upgrading of structures, roads, sewer or water facilities, or other conditions to be imposed or required within the affected territory.

N/A

5. Describe financial arrangements for construction and operation of services extended to the affected territory. Will the territory be subject to any special taxes, charges or fees? (If so, please specify.)

The County agreed to finance 50% of the cost, not-to-exceed \$50,000, for the construction of a U-Turn Pocket as described above. The Construction has been completed and the County has paid the shared cost. There will be zero tax exchanges pursuant to Section 99 et.

seg. of the Revenue and Taxation Code for annexations of roadways where no property taxes are involved.

6. In as much detail as required to give a clear explanation, explain why this proposal is necessary at this time. To place into one jurisdiction, all of Guadalupe Canyon Parkway in the area where a U-turn pocket was constructed to allow safe turning movements on Guadalupe Canyon Parkway for the parents/relatives/care givers that drop off or pick up children at the John F. Kennedy School that is located in the City of Daly City

This section completed by San Mateo County, Department of Public Works

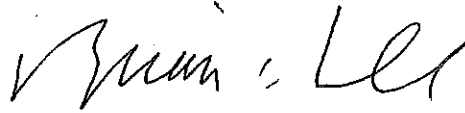

Brian C. Lee, Acting Director of Public Works
(Name) (Title)

PROPOSED ANNEXATION TO THE CITY OF DALY CITY EXHIBIT "A"

PAGE 1 OF 2

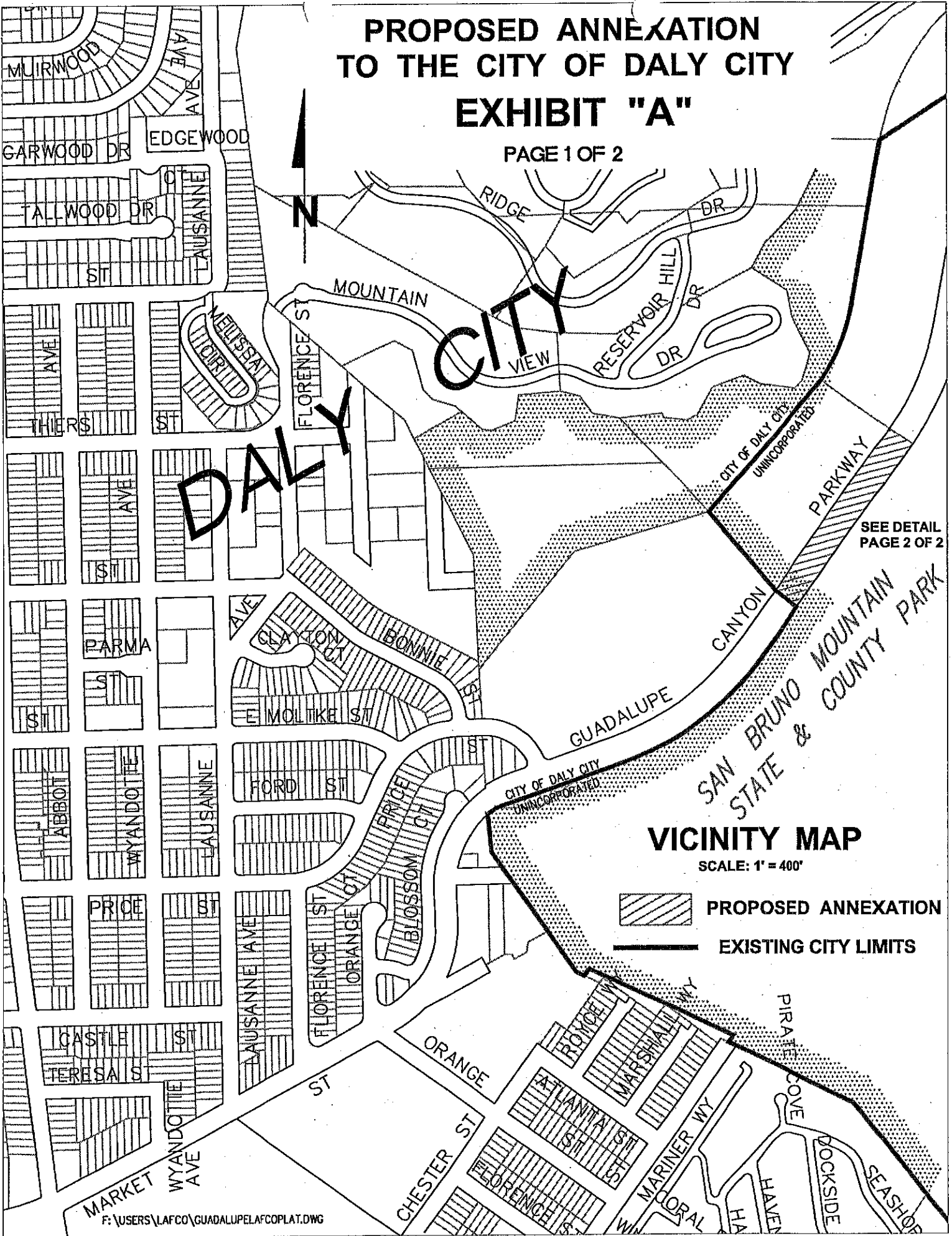

SEE DETAIL
PAGE 2 OF 2

VICINITY MAP

SCALE: 1" = 400'

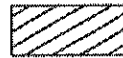

PROPOSED ANNEXATION



EXISTING CITY LIMITS

BEING A PORTION OF THE CANADA DE GUADALUPE LA VISITACION Y RODEO VIEJO RANCHO

CITY OF DALY CITY
UNINCORPORATED

#90004704

GUADALUPE CANYON PARKWAY

②

721.26' N 35°41'41" E

4586 O.R. 537

④

721.26' S 35°41'26" W

③

100' S 54°18'19" E

ORD. No. 803

P.O.B.

50' N 54°18'00" W

①

215.73' N 35°41'41" E

50' N 54°18'00" W

⑤

MON. #254



DETAIL

SCALE: 1" = 100'

EXHIBIT " A "

EXHIBIT "A"

PROPOSED ANNEXATION TO THE CITY OF DALY CITY

(PORTION OF GUADALUPE CANYON PARKWAY SITUATED IN THE CANADA DE GUADALUPE LA VISITACION Y RODEO VIEJO RANCHO)

Beginning at the intersection of the centerline of Guadalupe Canyon Parkway (100 feet in width) as described in the Deed of Easement recorded in Volume 4586 Official Records at Page 337, San Mateo County Recorder's Office and the northeasterly City Limit line of Daly City as described in Ordinance No. 803, passed and adopted on June 23, 1975, said point being distant North 35° 41' 41" East 215.73 (called North 35° 42' East 215.85 feet in said deed) from San Mateo County Monument No. 254, as shown on the Record of Survey filed in Volume 9 at Page 2, Records of San Mateo County; Thence from said Point of Beginning North 54° 18' West (called North 55° 12' 30" West in said Ord.) along said City Limit line 50 feet, to the northwesterly line of said Guadalupe Canyon Parkway; Thence leaving said City Limit line North 35° 41' 41" East (called North 35° 42' East in said deed) along said northwesterly line 721.26 feet to the easterly corner of parcel of land described in the Deed recorded in San Mateo County Recorder's File No. 90004704; Thence leaving said line, South 54° 18' 19" East 100 feet to a point in the southeasterly line of said Guadalupe Canyon Parkway; Thence South 35° 41' 41" West (called South 35° 42' West in said deed 4586 or 337) 721.26 feet along said line to an angle point in said aforementioned City Limits; Thence leaving said southeasterly line North 55° 12' 30" West along said City Limit line, 50 feet to the Point of Beginning.

Containing 1.66 acres more or less.

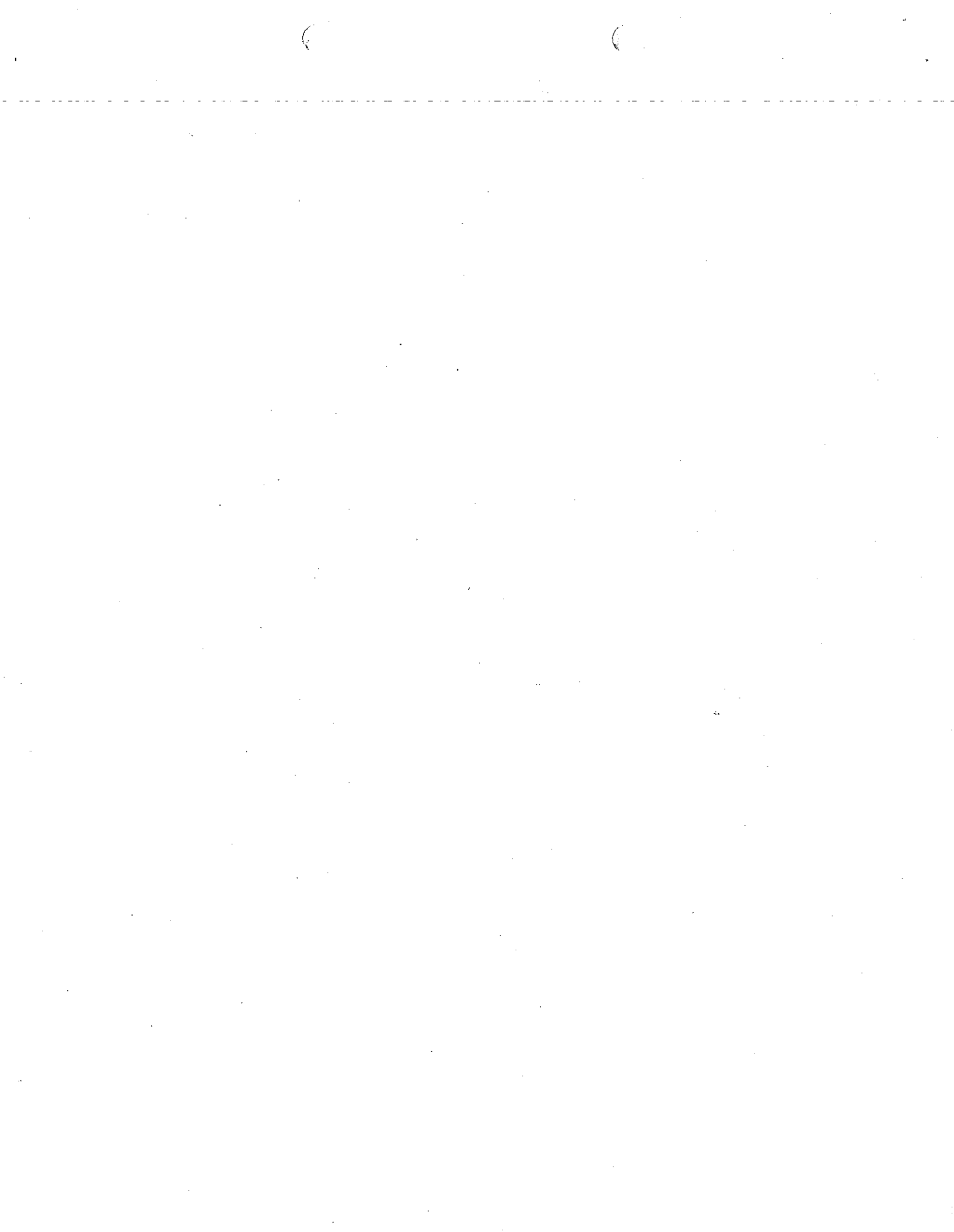

m. Payatos

Resolution No. 088472

Board of Supervisors, County of San Mateo, State of California

* * * * *

A Resolution of Application by the County of San Mateo Requesting the Local Agency Formation Commission to Take Proceedings for a Minor Sphere of Influence Amendment and for the Annexation of a Portion of Guadalupe Canyon Parkway to the City of Daly City; and Authorizing the Director of Public Works or His Designee, to Sign all Necessary Applications or Other Documents Associated with the Proposed Annexation

RESOLVED, by the County of San Mateo, State of California, that

WHEREAS, the County of San Mateo desires to initiate proceedings pursuant to the Cortese-Knox-Hertzberg Local Government Reorganization Act of 2000, commencing with Section 56000 of the California Government Code, for the Proposed Annexation of a portion of Guadalupe Canyon Parkway to the City of Daly City; and

WHEREAS, the territory proposed to be annexed is uninhabited, and a description of the boundaries of the territory is set forth in Exhibit "A" attached hereto and by this reference incorporated herein; and

WHEREAS, the roadway proposed for annexation is not currently within the sphere of influence of the City of Daly City and it is appropriate that the City's sphere of influence be amended to include the territory; and

WHEREAS, the reason for the proposed annexation is to place that portion of Guadalupe Canyon Parkway in the area where a U-turn Pocket and advance warning signs were constructed to allow safe turning movements for the parents/relatives/care givers that drop off or pick up

children at the John F. Kennedy School that is located in the City of Daly City, entirely within one jurisdiction; and

WHEREAS, this Board certifies that this proposal is exempt from the provisions of the California Environmental Quality Act pursuant to Section 15319 of Title 14 of the California Code of Regulations, "Annexations of Existing Facilities and Lots for Exempt Facilities."

NOW, THEREFORE, IT IS HEREBY ORDERED AND DETERMINED, that

- 1) this Resolution of Application is hereby adopted by this Board of Supervisors, and the Local Agency Formation Commission of San Mateo County is hereby requested to take proceedings for a minor sphere of influence amendment and the annexation of a portion of Guadalupe Canyon Parkway to the City of Daly City as described in Exhibit "A" attached hereto, and in the manner provided by the Cortese-Knox-Hertzberg Local Government Reorganization Act of 2000.
- 2) the Director of Public Works, or his designee, is hereby authorized to sign all necessary applications and other documents that may be necessary to process said annexation.

* * * * *

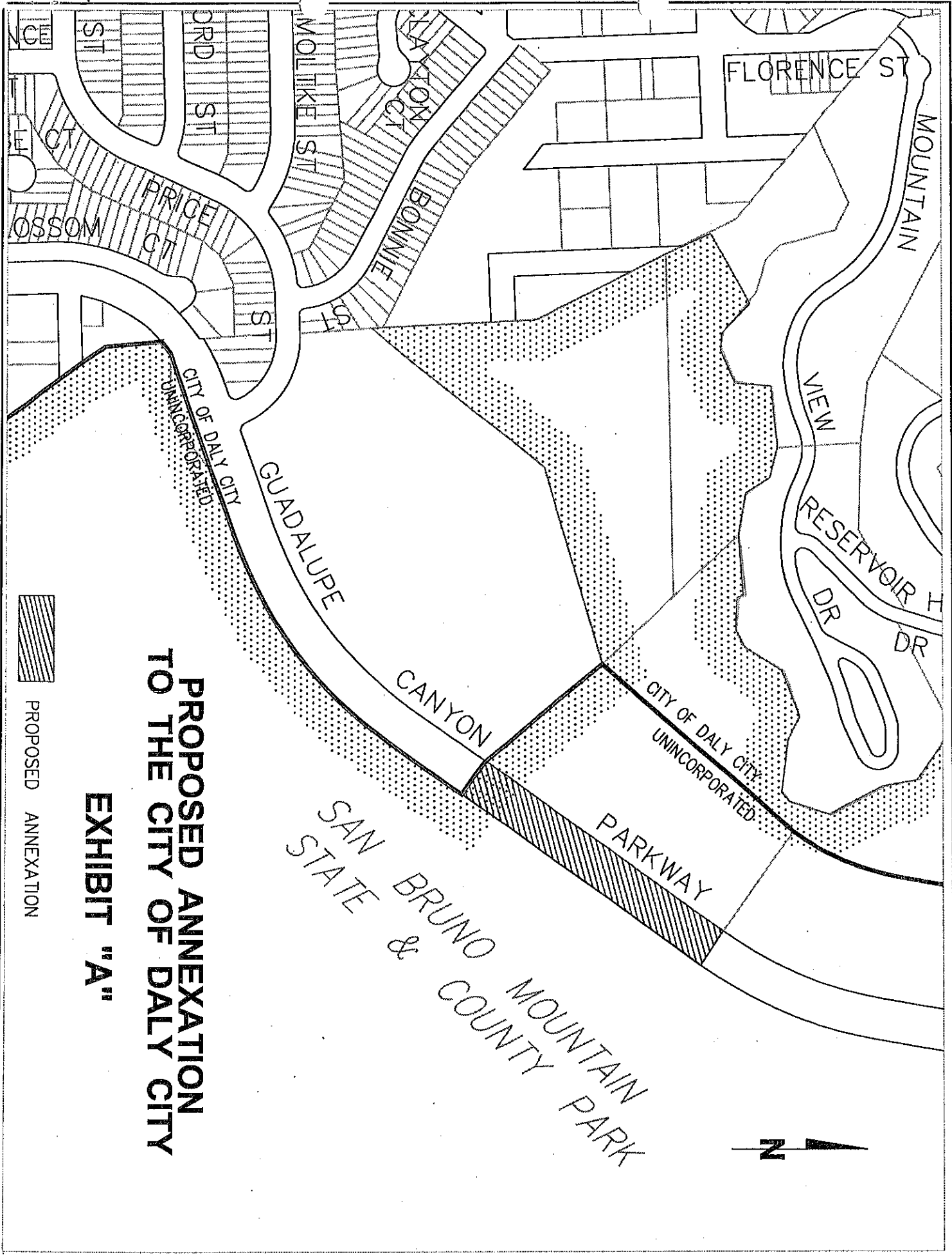

**PROPOSED ANNEXATION
TO THE CITY OF DALY CITY
EXHIBIT "A"**

 PROPOSED ANNEXATION



(

(

11-17

[The remainder of the page is blank with minor scanning artifacts.]

Regularly passed and adopted this 9th day of January, 2007.

AYES and in favor of said resolution:

Supervisors:

MARK CHURCH

JERRY HILL

RICHARD S. GORDON

ROSE JACOBS GIBSON

ADRIENNE J. TISSIER

NOES and against said resolution:

Supervisors:

NONE

Absent Supervisors:

NONE

Rose Jacobs Gibson

President, Board of Supervisors
County of San Mateo
State of California

Certificate of Delivery

I certify that a copy of the original resolution filed in the Office of the Clerk of the Board of Supervisors of San Mateo County has been delivered to the President of the Board of Supervisors.

Marie L. Peterson

Marie L. Peterson, Deputy
Clerk of the Board of Supervisors

(

(

1000

